

EASTER RABBIT TRICK

IT WILL LOOK LIKE MAGIC
WHEN YOU OPEN
THE WINE WITH THE
RABBIT® CORKSCREW-
BUT IT'S AS EASY AS 1,2,3

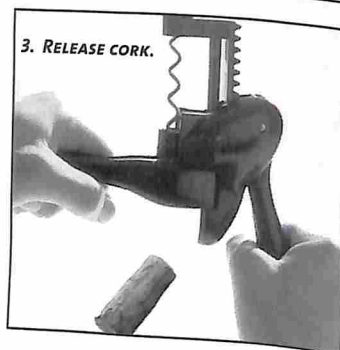
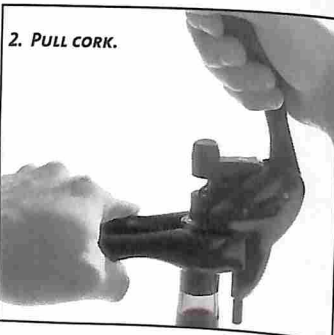
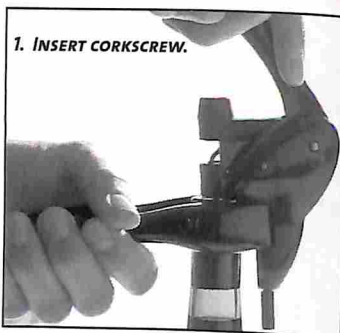

WHERE TO GO RABBIT HUNTING:
AMAZON.COM, CHEF'S CATALOG,
CRATE & BARREL, FORTUNOFF,
HECHT COMPANY, KAUFMANN'S,
LE GOURMET CHEF, SUR LA TABLE
OR YOUR FAVORITE WINE STORE.

Rabbit
corkscrew
by Metrokane

See the Rabbit run at metrokane.com
D430994 and other U.S. Patents

THE NEW YORKER, APRIL 1, 2002



THE NEW YORKER

APRIL 1, 2002

- 12 GOINGS ON ABOUT TOWN
35 THE TALK OF THE TOWN
The Church crisis; spring-training notes.
- Nicholas Lemann 42 LETTER FROM WASHINGTON
The Next World Order
Bill Franzen 49 SHOUTS & MURMURS
You Can Help
Rebecca Mead 50 LETTER FROM SOUTH PADRE ISLAND
Endless Spring
Robert A. Caro 56 ANNALS OF POLITICS
Life as a professional spring breaker.
Robert Polidori, Paul Goldberger 72 THE SKY LINE
The Tweed Courthouse.
Don DeLillo 78 FICTION
"Baader-Meinhof"
- John LaBr 84 THE CRITICS
THE THEATRE
"Oklahoma!"
Peter Schjeldahl 87 THE ART WORLD
"Mirroring Evil," at the Jewish Museum.
Adam Gopnik 88 A CRITIC AT LARGE
Visiting Karl Popper.
BOOKS
John Updike 93 Briefly Noted
Alex Ross 94 Michael Frayn's "Spies."
96 MUSICAL EVENTS
City Opera vs. Lincoln Center.
David Denby 98 THE CURRENT CINEMA
"The Piano Teacher."
- Susan Minot 52 POEMS
W.S. Merwin 66 "The Toast"
"To Zbigniew Herbert's Bicycle"

COVER "Spring Is Here," by Roz Chast THE BACK PAGE "Baseball Records That May
Never Fall," by Barry Blitt DRAWINGS Robert Mankoff, Jack Ziegler, Mike Twohy,
Alex Gregory, Robert Weber, Bruce Eric Kaplan, Mick Stevens, Danny Shanahan,
Peter Steiner, Michael Crawford, Tom Cheney, Frank Cotham, Charles Barsotti, Roz
Chast, George Booth, Gahan Wilson, P.C. Vey

www.newyorker.com

T H E L E X U S L S 4 3 0



So there you are one day, sitting alone
inside the Lexus LS 430 talking to yourself,
when you hear a little voice talk
back. Are you going mad?

Perhaps not.

Perhaps, just maybe,
the voice you hear is the
voice-activated Lexus DVD
Navigation System* that responds
to 150 spoken commands. By pressing a
switch on the steering wheel and uttering
a word or phrase such as "restaurant" or
"gas station," the system will show you the
desired destination on a display screen map
and a voice will ingeniously guide you.

Can an automobile delight, comfort, fascinate and energize you?
Take lexus.com for a test drive. The Passionate Pursuit of Perfection.

Perhaps the voice that you hear is from
the available Lexus Link system. A touch
of a button lets you speak to an
advisor who can send for
emergency medical help
or Roadside Assistance.
The system knows your
location, even if you don't,
courtesy of a highly sophisticated

Global Positioning System (GPS)†
Perhaps the voice you are listening to
is your own. A device inside the LS 430 lets
you conveniently record a memo.‡

Or perhaps not.
Maybe you should stop talking to cars.

SOME
PEOPLE TALK
TO THEIR CARS.
A LEXUS WILL ACTUALLY
TALK BACK.

LEXUS

*Optional. The Lexus DVD Navigation System is designed to assist in locating an address or point of interest. Discrepancies may be encountered between the system and your actual location. Changes in street names, road closures, traffic flow or other road system changes may affect the accuracy of the mapping software. Rely upon your common sense to decide whether or not to follow a specified route. Detailed coverage not available in every city. See the Navigation Owners Manual and your Lexus dealer for further details. †Coverage only available in the continental U.S. and Canada. See your local Lexus dealer for details on our Roadside Assistance program. Contact with the Lexus Link Call Center is limited to analog cellular service areas. Therefore you may sometimes be unable to contact the Lexus Link Call Center or receive emergency service support. ‡Included with available Lexus Link system. ©2001 Lexus, a Division of Toyota Motor Sales, U.S.A., Inc. Lexus reminds you to wear seatbelts, secure children in rear seat, obey all speed laws and drive responsibly. For more information, call 800-USA-LEXUS (800-872-5398).

PRICE \$3.50

APRIL 2002

THE NEW YORKER



#BXBCMCJ**CR-L0T 0009D**C0-09
#NYR0541154787/9#
3019 W 43RD ST
MINNEAPOLIS MN 55410-1518
M-M DOUG WILHIDE
87 SEP2302
NX PG

N. Cunt